

ONYX - XS

ONYX-XS is a gate barrier with a special wall mounting design. Special fastening principle gives the option of fitting to up standing surfaces. This is an efficient solution with compact dimensions combined with an affordable price.

Ergonomic design with stylish body lines and the inclined scratch resistant glass top gives this turnstile a futuristic look making it a stylish architectural element to compliment any modern interior.

Onyx-XS turnstiles are equipped with an automatic bi-directional servo-drive mechanism with a robust locking system

Onyx-XS has a robust hub with stainless steel arms and a fully automatic anti-panic system



SMALL-SIZED RELIABLE TRIPOD TURNSTILE WITH WALL MOUNTING



60
pers/min

FREE ACCESS



25
pers/min

CROSSING CAPACITY



600
mm

PASSAGE WIDTH



41

PROTECTIVE LEVEL



DROP-ARM



SERVO-DRIVEN



BI-DIRECTIONAL

Advantages

- Ergonomical design with stylish lines
- Servo-driven tripod turnstile with anti-panic system / bar drop-arm function
- Anti-panic function with automatic reset
- Successful combination of affordable price and high quality
- Integration with any type of access control and ID systems
- Low power consumption
- Whisper quiet, low noise operation
- Compact and quick to install
- Wide range of accessories
- Wired remote control is in a standard kit
- 4 LED indicators
- Supply of backup battery power connection
- Place for RFID readers under the top glass
- Turnstile is supplied ready for installation

Options

- Any additional devices upon request (e.g. passage counter, RFID/Proximity/BioMetric readers, coin acceptor, push button, barcode and QR-code reader)
- Wireless remote control
- Jumping over the arm alarm / top lid alarm
- Passage simulation alarm
- Crawling under the arm alarm
- OEM / Logo application
- Ramped base mobile platform



www.tiso.global
+380 (44) 291-21-11
e-mail: sales@tiso.global



Technical Specifications:

Width, mm	380
Length, mm	837
Height, mm	741
Mechanism	servo-driven
MCBF, cycles	5 000 000

Controlled by:



access control system;



push button control unit

Electrical Specifications:

- Voltage:
 - from the AC (100-240)V, 50/60Hz;
 - from a DC source 12 V;
- Maximum power consumption 55W per pass;

Ambient temperature range:

- Standard: from +1°C to +40°C, up to IP41

Materials:

Standard housing	Brushed SS AISI 304
Available housing	Brushed SS AISI 316 Polished SS AISI 304 Polished SS AISI 316 Powder coated RAL
Tripod hub	Cast aluminum with with stainless steel arms

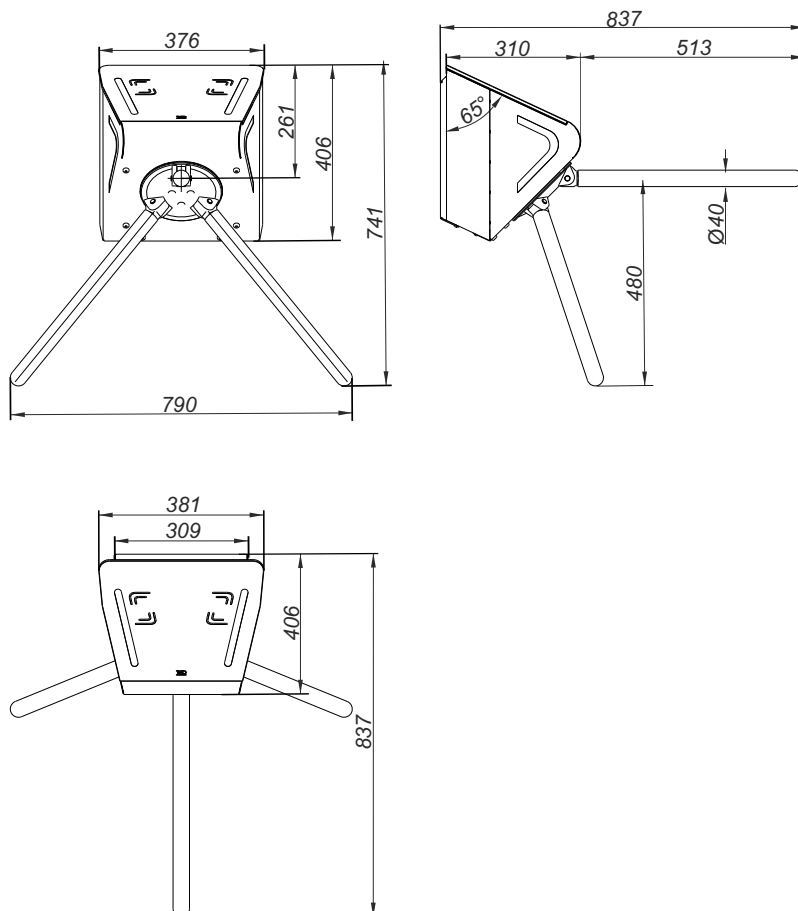

Installation areas:

- Governmental Institutions
- Military Bases
- Nuclear Power Plants
- Production sites (Industrial Plants)
- Commercial areas
- Financial institutions
- Airport Premises
- Business (Office) Centers
- Hotels
- Sport Complexes
- Recreation areas
- Urban areas
- Education Institutions and others

